

## ECCO SHOWER MIXER

### SPECIFICATION

PRODUCT CODE	YSW3013-09
WELS RATING	N/A
WATERMARK LICENSE	WM-060073
TEMPERATURE RATING	MIN 1°C-MAX 75°C
PRESSURE RATING	MIN 150KPa-MAX 500KPa



### FINISH

	CHROME NR301309CH		MATTE BLACK NR301309MB
	BRUSHED NICKEL NR301309BN		WHITE CHROME NR301309CW

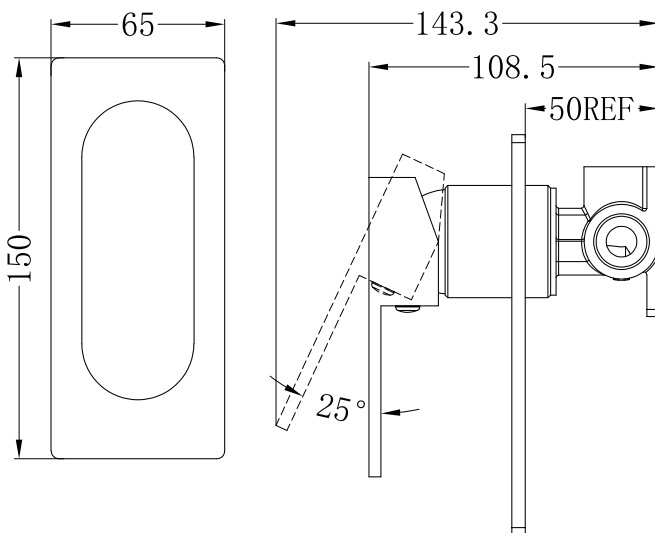

Dimensions are nominal measurements only.

### MAINTENANCE AND CARE

All surfaces should be cleaned with mild liquid detergent or soap and water.

Do not use cream cleaners or citrus based cleaning products, as they are abrasive.

Use of unsuitable cleaning agents may damage the surface. Any damage caused in this way will not be covered by warranty.

### PACKING INCLUDES

- 1x mixer body
- 1x handle
- 1x plate
- 1x installation kit



## Installation Instruction

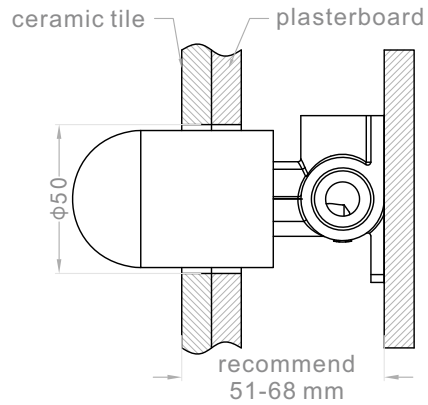

1. Fix body on noggin and ensure installation depth is 51-68mm from noggin to ceramic tile.
2. Connect cold water hose and hot water hose and test for leakage.
3. Install plasterboard and ceramic tile after drilling a  $\phi 50$  hole according to above picture.

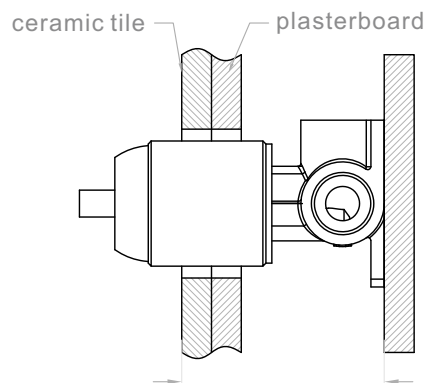

4. Remove the plastic sleeve of body.

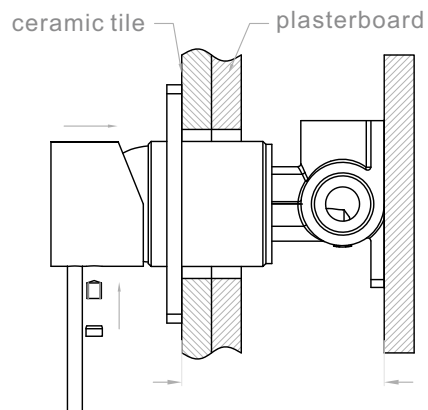

5. Install plate and handle.